



TRAFFIC CRASH REPORT

LOCAL REPORT NUMBER *	CRASH SEVERITY	HIT/SKIP
2018-00009415	3 1 - FATAL 2 - INJURY 3 - PDO	2 1 - SOLVED 2 - UNSOLVED

LOCAL INFORMATION
Newark Police Dept.

<input checked="" type="checkbox"/> PHOTOS TAKEN <input type="checkbox"/> OH-2 <input checked="" type="checkbox"/> OH-1P <input type="checkbox"/> OH-3 <input type="checkbox"/> OTHER	<input type="checkbox"/> PDO UNDER STATE REPORTABLE DOLLAR AMOUNT	<input checked="" type="checkbox"/> PRIVATE PROPERTY	REPORTING AGENCY NCIC * 04501	REPORTING AGENCY NAME * Newark Police Department	NUMBER OF UNITS 20	UNIT IN ERROR 01 98 - ANIMAL 99 - UNKNOWN
---	---	--	---	--	------------------------------	---

COUNTY * 45	<input checked="" type="checkbox"/> CITY * <input type="checkbox"/> VILLAGE * <input type="checkbox"/> TOWNSHIP *	CITY, VILLAGE, TOWNSHIP * NEWARK	CRASH DATE * 04052018	TIME OF CRASH 1752	DAY OF WEEK Thu
-----------------------	---	--	---------------------------------	------------------------------	---------------------------

DEGREES / MINUTES / SECONDS LATITUDE	LONGITUDE	DECIMAL DEGREES LATITUDE	LONGITUDE
0 / 0 / 0	0 / 0 / 0	40.058953	-81.244573

ROADWAY DIVISION <input type="checkbox"/> DIVIDED <input checked="" type="checkbox"/> UNDIVIDED	DIVIDED LANE DIRECTION OF TRAVEL N - NORTHBOUND E - EASTBOUND S - SOUTHBOUND W - WESTBOUND	NUMBER OF THRU LANES 02	ROAD TYPES OR MILEPOST ² AL - ALLEY CR - CIRCLE HE - HEIGHTS MP - MILEPOST PL - PLACE ST - STREET WA - WAY AV - AVENUE CT - COURT HW - HIGHWAY PK - PARKWAY RD - ROAD TE - TERRACE BL - BOULEVARD DR - DRIVE LA - LANE PI - PIKE SQ - SQUARE TL - TRAIL
---	--	-----------------------------------	---

LOCATION ROUTE NUMBER 01	LOC PREFIX N, S, E, W	LOCATION ROAD NAME HIGHLAND	ROUTE TYPES ¹ IR - INTERSTATE ROUTE (INC. TURNPIKE) CR - NUMBERED COUNTY ROUTE US - US ROUTE TR - NUMBERED TOWNSHIP ROUTE SR - STATE ROUTE
------------------------------------	--------------------------	---------------------------------------	--

DISTANCE FROM REFERENCE 50	DIR FROM REF N, S, E, W S	REFERENCE ROUTE NUMBER 01	REF PREFIX N, S, E, W	REFERENCE NAME (ROAD, MILEPOST, HOUSE #) 500 HIGHLAND	REFERENCE ROAD TYPE ² BL
--------------------------------------	--	-------------------------------------	--------------------------	---	---

REFERENCE POINT USED 3 1 - INTERSECTION 2 - MILE POST 3 - HOUSE NUMBER	CRASH LOCATION 01 01 - NOT AN INTERSECTION 06 - FIVE-POINT, OR MORE 02 - FOUR-WAY INTERSECTION 07 - ON RAMP 03 - T-INTERSECTION 08 - OFF RAMP 04 - Y-INTERSECTION 09 - CROSSOVER 05 - TRAFFIC CIRCLE/ROUNDOUT 10 - DRIVEWAY/ALLEY ACCESS	<input type="checkbox"/> INTERSECTION RELATED	LOCATION OF FIRST HARMFUL EVENT 6 1 - ON ROADWAY 5 - ON GORE 2 - ON SHOULDER 6 - OUTSIDE TRAFFICWAY 3 - IN MEDIAN 9 - UNKNOWN 4 - ON ROADSIDE
---	---	---	---

ROAD CONTOUR 1 1 - STRAIGHT LEVEL 4 - CURVE GRADE 2 - STRAIGHT GRADE 9 - UNKNOWN 3 - CURVE LEVEL	ROAD CONDITIONS PRIMARY 01 SECONDARY 01 - DRY 05 - SAND, MUD, DIRT, OIL, GRAVEL 09 - RUT, HOLES, BUMPS, UNEVEN PAVEMENT* 02 - WET 06 - WATER (STANDING, MOVING) 10 - OTHER 03 - SNOW 07 - SLUSH 99 - UNKNOWN 04 - ICE 08 - DEBRIS*	* SECONDARY CONDITION ONLY
---	--	----------------------------

MANNER OF CRASH COLLISION/IMPACT 9 1 - NOT COLLISION BETWEEN TWO MOTOR VEHICLES IN TRANSPORT 2 - REAR-END 3 - HEAD-ON 4 - REAR-TO-REAR 5 - BACKING 6 - ANGLE 7 - SIDESWIPE, SAME DIRECTION 8 - SIDESWIPE, OPPOSITE DIRECTION 9 - UNKNOWN	WEATHER 1 1 - CLEAR 4 - RAIN 7 - SEVERE CROSSWINDS 2 - CLOUDY 5 - SLEET, HAIL 8 - BLOWING SAND, SOIL, DIRT, SNOW 3 - FOG, SMOG, SMOKE 6 - SNOW 9 - OTHER/UNKNOWN
--	---

ROAD SURFACE 2 1 - CONCRETE 4 - SLAG, GRAVEL, STONE 2 - BLACKTOP, BITUMINOUS, ASPHALT 5 - DIRT 3 - BRICK/BLOCK 6 - OTHER	LIGHT CONDITIONS PRIMARY 1 SECONDARY 1 - DAYLIGHT 5 - DARK - ROADWAY NOT LIGHTED 9 - UNKNOWN 2 - DAWN 6 - DARK - UNKNOWN ROADWAY LIGHTING 3 - DUSK 7 - GLARE* 4 - DARK - LIGHTED ROADWAY 8 - OTHER	<input type="checkbox"/> SCHOOL BUS RELATED <input type="checkbox"/> YES, SCHOOL BUS DIRECTLY INVOLVED <input type="checkbox"/> YES, SCHOOL BUS INDIRECTLY INVOLVED
---	--	---

<input type="checkbox"/> WORK ZONE RELATED <input type="checkbox"/> WORKERS PRESENT <input type="checkbox"/> LAW ENFORCEMENT PRESENT (OFFICER/VEHICLE) <input type="checkbox"/> LAW ENFORCEMENT PRESENT (VEHICLE ONLY)	TYPE OF WORK ZONE <input type="checkbox"/> 1 - LANE CLOSURE 4 - INTERMITTENT OR MOVING WORK 2 - LANE SHIFT/CROSSOVER 5 - OTHER 3 - WORK ON SHOULDER OR MEDIAN	LOCATION OF CRASH IN WORK ZONE <input type="checkbox"/> 1 - BEFORE THE FIRST WORK ZONE WARNING SIGN 4 - ACTIVITY AREA 2 - ADVANCE WARNING AREA 5 - TERMINATION AREA 3 - TRANSITION AREA
---	--	--

NARRATIVE
UNIT 2 WAS PARKED IN THE PARKING LOT. WHEN THE DRIVER RETURNED HIS CAR WAS DAMAGED ON THE LEFT SIDE.

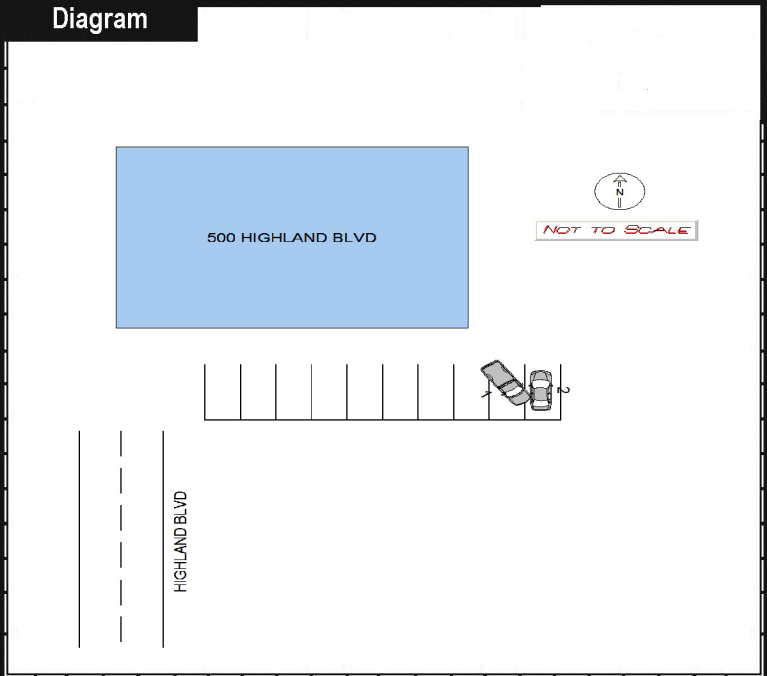

REPORT TAKEN BY <input checked="" type="checkbox"/> POLICE AGENCY <input type="checkbox"/> MOTORIST	<input type="checkbox"/> SUPPLEMENT (CORRECTION OR ADDITION TO AN EXISTING REPORT SENT TO ODPS)	DATE CRASH REPORTED 04052018	TIME CRASH REPORTED 1752	DISPATCH TIME 1752	ARRIVAL TIME 1759	TIME CLEARED 1820	OTHER INVESTIGATION TIME	TOTAL MINUTES
OFFICER'S NAME * Stevens, Coury	OFFICER'S BADGE NUMBER 45NPD-360	CHECKED BY	PAGE 1 OF 4					



UNIT

LOCAL REPORT NUMBER

2018-00009415

UNIT NUMBER 01	OWNER NAME: LAST, FIRST, MIDDLE (<input checked="" type="checkbox"/> SAME AS DRIVER) UNKNOWN, 01, 2018-00009415	OWNER PHONE NUMBER - INC. AREA CODE (<input type="checkbox"/> SAME AS DRIVER)	DAMAGE SCALE 9	DAMAGED AREA 	
OWNER ADDRESS: CITY, STATE, ZIP (<input type="checkbox"/> SAME AS DRIVER)			CARRIER PHONE - INCLUDE AREA CODE		
LP STATE	LICENSE PLATE NUMBER	VEHICLE IDENTIFICATION NUMBER	# OCCUPANTS		
VEHICLE YEAR	VEHICLE MAKE	VEHICLE MODEL	VEHICLE COLOR		
<input type="checkbox"/> PROOF OF INSURANCE SHOWN	INSURANCE COMPANY	POLICY NUMBER	TOWED BY		
CARRIER NAME, ADDRESS, CITY, STATE, ZIP			CARRIER PHONE - INCLUDE AREA CODE		
US DOT	VEHICLE WEIGHT GVWR/GCWR 1 - LESS THAN OR EQUAL TO 10K LBS. 2 - 10,001 TO 26,000 LBS. 3 - MORE THAN 26,000 LBS.	CARGO BODY TYPE 01 - NO CARGO BODY TYPE/NOT APPLICABLE 02 - BUS/VAN (9-15 SEATS, INC DRIVER) 03 - BUS (16+ SEATS, INC DRIVER) 04 - VEHICLE TOWING ANOTHER VEHICLE 05 - LOGGING 06 - INTERMODAL CONTAINER CHASSIS 07 - CARGO VAN/ENCLOSED BOX 08 - GRAIN, CHIPS, GRAVEL	TRAFFICWAY DESCRIPTION 01 - TWO-WAY, NOT DIVIDED 02 - TWO-WAY, NOT DIVIDED, CONTINUOUS LEFT TURN LANE 03 - TWO-WAY, DIVIDED, UNPROTECTED (PAINTED OR GRASS >4 FT) MEDIAN 04 - TWO-WAY, DIVIDED, POSITIVE MEDIAN BARRIER 05 - ONE-WAY TRAFFICWAY <input checked="" type="checkbox"/> HIT / SKIP UNIT		
HM PLACARD ID NO.	<input type="checkbox"/> HAZARDOUS MATERIAL RELEASED	PASSENGER VEHICLES (LESS THAN 9 PASSENGERS) 01 - SUB-COMPACT 02 - COMPACT 03 - MID SIZE 04 - FULL SIZE 05 - MINIVAN 06 - SPORT UTILITY VEHICLE 07 - PICKUP 08 - VAN 09 - MOTORCYCLE 10 - MOTORIZED BICYCLE 11 - SNOWMOBILE/ATV 12 - OTHER PASSENGER VEHICLE MED/HEAVY TRUCKS OR COMBO UNITS > 10K LBS 13 - SINGLE UNIT TRUCK OR VAN 2AXLE, 6 TIRES 14 - SINGLE UNIT TRUCK; 3+ AXLES 15 - SINGLE UNIT TRUCK / TRAILER 16 - TRUCK/TRACTOR (BOBTAIL) 17 - TRACTOR/SEMI-TRAILER 18 - TRACTOR/DOUBLE 19 - TRACTOR/TRIPLES 20 - OTHER MED/HEAVY VEHICLE BUS/VAN/LIMO (9 OR MORE INCLUDING DRIVER) 21 - BUS/VAN (9-15 SEATS, INC DRIVER) 22 - BUS (16+ SEATS, INC DRIVER) NON-MOTORIST 23 - ANIMAL WITH RIDER 24 - ANIMAL WITH BUGGY, WAGON, SURREY 25 - BICYCLE/PEDALCYCLIST 26 - PEDESTRIAN/SKATER 27 - OTHER NON-MOTORIST			
NON-MOTORIST LOCATION PRIOR TO IMPACT 01 - INTERSECTION - MARKED CROSSWALK 02 - INTERSECTION - NO CROSSWALK 03 - INTERSECTION - OTHER 04 - MIDBLOCK - MARKED CROSSWALK 05 - TRAVEL LANE - OTHER LOCATION 06 - BICYCLE LANE 07 - SHOULDER/ROADSIDE 08 - SIDEWALK 09 - MEDIAN/CROSSING ISLAND 10 - DRIVEWAY ACCESS 11 - SHARED-USE PATH OR TRAIL 12 - NON-TRAFFICWAY AREA 99 - OTHER/UNKNOWN	TYPE OF USE 1 - PERSONAL 2 - COMMERCIAL 3 - GOVERNMENT <input type="checkbox"/> IN EMERGENCY RESPONSE	UNIT TYPE 99 99 - UNKNOWN OR HIT / SKIP	<input type="checkbox"/> HAS HM PLACARD		
SPECIAL FUNCTION 01 - NONE 02 - TAXI 03 - RENTAL TRUCK (OVER 10K LBS) 04 - BUS - SCHOOL (PUBLIC OR PRIVATE) 05 - BUS - TRANSIT 06 - BUS - CHARTER 07 - BUS - SHUTTLE 08 - BUS - OTHER	09 - AMBULANCE 10 - FIRE 11 - HIGHWAY/MAINTENANCE 12 - MILITARY 13 - POLICE 14 - PUBLIC UTILITY 15 - OTHER GOVERNMENT 16 - CONSTRUCTION EQUIP.	17 - FARM VEHICLE 18 - FARM EQUIPMENT 19 - MOTORHOME 20 - GOLF CART 21 - TRAIN 22 - OTHER (EXPLAIN IN NARRATIVE)	MOST DAMAGED AREA 99 IMPACT AREA 99	01 - NONE 02 - CENTER FRONT 03 - RIGHT FRONT 04 - RIGHT SIDE 05 - RIGHT REAR 06 - REAR CENTER 07 - LEFT REAR 08 - LEFT SIDE 09 - LEFT FRONT 10 - TOP AND WINDOWS 11 - UNDERCARRIAGE 12 - LOAD/TRAILER 13 - TOTAL(ALL AREAS) 14 - OTHER 99 - UNKNOWN	ACTION 3 1 - NON-CONTACT 2 - NON-COLLISION 3 - STRIKING 4 - STRUCK 5 - STRIKING/STRUCK 9 - UNKNOWN
PRE-CRASH ACTIONS 99 99 - UNKNOWN	MOTORIST 01 - STRAIGHT AHEAD 02 - BACKING 03 - CHANGING LANES 04 - OVERTAKING/PASSING 05 - MAKING RIGHT TURN 06 - MAKING LEFT TURN 07 - MAKING U-TURN 08 - ENTERING TRAFFIC LANE 09 - LEAVING TRAFFIC LANE 10 - PARKED 11 - SLOWING OR STOPPED IN TRAFFIC 12 - DRIVERLESS	13 - NEGOTIATING A CURVE 14 - OTHER MOTORIST ACTION	NON-MOTORIST 15 - ENTERING OR CROSSING SPECIFIED LOCATION 16 - WALKING, RUNNING, JOGGING, PLAYING, CYCLING 17 - WORKING 18 - PUSHING VEHICLE 19 - APPROACHING OR LEAVING VEHICLE 20 - STANDING 21 - OTHER NON-MOTORIST ACTION		
CONTRIBUTING CIRCUMSTANCES PRIMARY 99 SECONDARY 99 99 - UNKNOWN	MOTORIST 01 - NONE 02 - FAILURE TO YIELD 03 - RAN RED LIGHT 04 - RAN STOP SIGN 05 - EXCEEDED SPEED LIMIT 06 - UNSAFE SPEED 07 - IMPROPER TURN 08 - LEFT OF CENTER 09 - FOLLOWED TOO CLOSELY/ACDA 10 - IMPROPER LANE CHANGE /PASSING/OFF ROAD 11 - IMPROPER BACKING 12 - IMPROPER START FROM PARKED POSITION 13 - STOPPED OR PARKED ILLEGALLY 14 - OPERATING VEHICLE IN NEGLIGENCE MANNER 15 - SWERVING TO AVOID (DUE TO EXTERNAL CONDITIONS) 16 - WRONG SIDE/WRONG WAY 17 - FAILURE TO CONTROL 18 - VISION OBSTRUCTION 19 - OPERATING DEFECTIVE EQUIPMENT 20 - LOAD SHIFTING/FALLING/SPILLING 21 - OTHER IMPROPER ACTION	NON-MOTORIST 22 - NONE 23 - IMPROPER CROSSING 24 - DARTING 25 - LYING AND/OR ILLEGALLY IN ROADWAY 26 - FAILURE TO YIELD RIGHT OF WAY 27 - NOT VISIBLE (DARK CLOTHING) 28 - INATTENTIVE 29 - FAILURE TO OBEY TRAFFIC SIGNS /SIGNALS/OFFICER 30 - WRONG SIDE OF THE ROAD 31 - OTHER NON-MOTORIST ACTION	VEHICLE DEFECTS 99 01 - TURN SIGNALS 02 - HEAD LAMPS 03 - TAIL LAMPS 04 - BRAKES 05 - STEERING 06 - TIRE BLOWOUT 07 - WORN OR SLICK TIRES 08 - TRAILER EQUIPMENT DEFECTIVE 09 - MOTOR TROUBLE 10 - DISABLED FROM PRIOR ACCIDENT 11 - OTHER DEFECTS		
SEQUENCE OF EVENTS 1 20 2 21 3 99 4 99 5 99 6 99 FIRST HARMFUL EVENT 2 MOST HARMFUL EVENT 2 99 - UNKNOWN	NON-COLLISION EVENTS 01 - OVERTURN/ROLLOVER 02 - FIRE/EXPLOSION 03 - IMMERSION 04 - JACKKNIFE 05 - CARGO/EQUIPMENT LOSS OR SHIFT 06 - EQUIPMENT FAILURE (BLOWN TIRE, BRAKE FAILURE, ETC) 07 - SEPARATION OF UNITS 08 - RAN OFF ROAD RIGHT 09 - RAN OFF ROAD LEFT 10 - CROSS MEDIAN OR SUPPORT 11 - CROSS CENTER LINE OPPOSITE DIRECTION OF TRAVEL 12 - DOWNHILL RUNAWAY 13 - OTHER NON-COLLISION COLLISION WITH FIXED OBJECT 25 - IMPACT ATTENUATOR/CRASH CUSHION 26 - BRIDGE OVERHEAD STRUCTURE 27 - BRIDGE PIER OR ABUTMENT 28 - BRIDGE PARAPET 29 - BRIDGE RAIL 30 - GUARDRAIL FACE 31 - GUARDRAIL END 32 - PORTABLE BARRIER 33 - MEDIAN CABLE BARRIER 34 - MEDIAN GUARDRAIL BARRIER 35 - MEDIAN CONCRETE BARRIER 36 - MEDIAN OTHER BARRIER 37 - TRAFFIC SIGN POST 38 - OVERHEAD SIGN POST 39 - LIGHT/LUMINARIES SUPPORT 40 - UTILITY POLE 41 - OTHER POST, POLE OR SUPPORT 42 - CULVERT 43 - CURB 44 - DITCH 45 - EMBANKMENT 46 - FENCE 47 - MAILBOX 48 - TREE 49 - FIRE HYDRANT 50 - WORK ZONE MAINTENANCE EQUIPMENT 51 - WALL, BUILDING, TUNNEL 52 - OTHER FIXED OBJECT				
COLLISION WITH PERSON, VEHICLE OR OBJECT NOT FIXED 14 - PEDESTRIAN 15 - PEDALCYCLE 16 - RAILWAY VEHICLE (TRAIN, ENGINE) 17 - ANIMAL - FARM 18 - ANIMAL - DEER 19 - ANIMAL - OTHER 20 - MOTOR VEHICLE IN TRANSPORT 21 - PARKED MOTOR VEHICLE 22 - WORK ZONE MAINTENANCE EQUIPMENT 23 - STRUCK BY FALLING, SHIFTING CARGO OR ANYTHING SET IN MOTION BY A MOTOR VEHICLE 24 - OTHER MOVABLE OBJECT	COLLISION WITH FIXED OBJECT 25 - IMPACT ATTENUATOR/CRASH CUSHION 26 - BRIDGE OVERHEAD STRUCTURE 27 - BRIDGE PIER OR ABUTMENT 28 - BRIDGE PARAPET 29 - BRIDGE RAIL 30 - GUARDRAIL FACE 31 - GUARDRAIL END 32 - PORTABLE BARRIER 33 - MEDIAN CABLE BARRIER 34 - MEDIAN GUARDRAIL BARRIER 35 - MEDIAN CONCRETE BARRIER 36 - MEDIAN OTHER BARRIER 37 - TRAFFIC SIGN POST 38 - OVERHEAD SIGN POST 39 - LIGHT/LUMINARIES SUPPORT 40 - UTILITY POLE 41 - OTHER POST, POLE OR SUPPORT 42 - CULVERT 43 - CURB 44 - DITCH 45 - EMBANKMENT 46 - FENCE 47 - MAILBOX 48 - TREE 49 - FIRE HYDRANT 50 - WORK ZONE MAINTENANCE EQUIPMENT 51 - WALL, BUILDING, TUNNEL 52 - OTHER FIXED OBJECT				
UNIT SPEED 10 <input type="checkbox"/> STATED <input checked="" type="checkbox"/> ESTIMATED	POSTED SPEED 25	TRAFFIC CONTROL 01 01 - NO CONTROLS 02 - STOP SIGN 03 - YIELD SIGN 04 - TRAFFIC SIGNAL 05 - TRAFFIC FLASHERS 06 - SCHOOL ZONE 07 - RAILROAD CROSSBUCKS 08 - RAILROAD FLASHERS 09 - RAILROAD GATES 10 - CONSTRUCTION BARRICADE 11 - PERSON (FLAGGER, OFFICER) 12 - PAVEMENT MARKINGS 13 - CROSSWALK LINES 14 - WALK/DON'T WALK 15 - OTHER 16 - NOT REPORTED	UNIT DIRECTION FROM N TO S 1 - NORTH 2 - SOUTH 3 - EAST 4 - WEST 5 - NORTHEAST 6 - NORTHWEST 7 - SOUTHEAST 8 - SOUTHWEST 9 - UNKNOWN		



UNIT

LOCAL REPORT NUMBER

2018-00009415

UNIT NUMBER 02		OWNER NAME: LAST, FIRST, MIDDLE (<input type="checkbox"/> SAME AS DRIVER) PARKER, JOHN		OWNER PHONE NUMBER - INC. AREA CODE (<input checked="" type="checkbox"/> SAME AS DRIVER) 812-841-7837		DAMAGE SCALE 3		DAMAGED AREA 			
OWNER ADDRESS: CITY, STATE, ZIP (<input type="checkbox"/> SAME AS DRIVER) 4572 OLD PARIS RD, WEST TERRE HAUTE, IN											
LP STATE IN		LICENSE PLATE NUMBER VVP481		VEHICLE IDENTIFICATION NUMBER 1G1JC1241V7190917			# OCCUPANTS 1				
VEHICLE YEAR 1997		VEHICLE MAKE Toyota		VEHICLE MODEL CAVALIER		VEHICLE COLOR					
<input checked="" type="checkbox"/> PROOF OF INSURANCE SHOWN		INSURANCE COMPANY ALFA INSURANCE CORP.		POLICY NUMBER 14-13-006284801		TOWED BY					
CARRIER NAME, ADDRESS, CITY, STATE, ZIP								CARRIER PHONE - INCLUDE AREA CODE			
US DOT		VEHICLE WEIGHT GVWR/GCWR 1 - LESS THAN OR EQUAL TO 10K LBS. 2 - 10,001 TO 26,000 LBS. 3 - MORE THAN 26,000 LBS.		CARGO BODY TYPE <input type="checkbox"/> 01 - No CARGO BODY TYPE/NOT APPLICABLE <input type="checkbox"/> 02 - BUS/VAN (9-15 SEATS, INC DRIVER) <input type="checkbox"/> 03 - BUS (16+ SEATS, INC DRIVER) <input type="checkbox"/> 04 - VEHICLE TOWING ANOTHER VEHICLE <input type="checkbox"/> 05 - LOGGING <input type="checkbox"/> 06 - INTERMODAL CONTAINER CHASSIS <input type="checkbox"/> 07 - CARGO VAN/ENCLOSED BOX <input type="checkbox"/> 08 - GRAIN, CHIPS, GRAVEL		TRAFFICWAY DESCRIPTION <input type="checkbox"/> 1 - Two-Way, NOT DIVIDED <input type="checkbox"/> 2 - Two-Way, NOT DIVIDED, CONTINUOUS LEFT TURN LANE <input type="checkbox"/> 3 - Two-Way, DIVIDED, UNPROTECTED (PAINTED OR GRASS >4FT) MEDIAN <input type="checkbox"/> 4 - Two-Way, DIVIDED, POSITIVE MEDIAN BARRIER <input type="checkbox"/> 5 - One-Way TRAFFICWAY		<input type="checkbox"/> HIT / SKIP UNIT			
HM PLACARD ID No.		<input type="checkbox"/> HAZARDOUS MATERIAL RELEASED		PASSENGER VEHICLES (LESS THAN 9 PASSENGERS) 01 - SUB-COMPACT 02 - COMPACT 03 - MID SIZE 04 - FULL SIZE 05 - MINIVAN 06 - SPORT UTILITY VEHICLE 07 - PICKUP 08 - VAN 09 - MOTORCYCLE 10 - MOTORIZED BICYCLE 11 - SNOWMOBILE/ATV 12 - OTHER PASSENGER VEHICLE		MED/HEAVY TRUCKS OR COMBO UNITS > 10K LBS 13 - SINGLE UNIT TRUCK OR VAN 2AXLE, 6 TIRES 14 - SINGLE UNIT TRUCK; 3+ AXLES 15 - SINGLE UNIT TRUCK / TRAILER 16 - TRUCK/TRACTOR (BOBTAIL) 17 - TRACTOR/SEMI-TRAILER 18 - TRACTOR/DOUBLE 19 - TRACTOR/TRIPLES 20 - OTHER MED/HEAVY VEHICLE		BUS/VAN/LIMO (9 OR MORE INCLUDING DRIVER) 21 - BUS/VAN (9-15 SEATS, INC DRIVER) 22 - BUS (16+ SEATS, INC DRIVER) NON-MOTORIST 23 - ANIMAL WITH RIDER 24 - ANIMAL WITH BUGGY, WAGON, SURREY 25 - BICYCLE/PEDACYCLIST 26 - PEDESTRIAN/SKATER 27 - OTHER NON-MOTORIST			
NON-MOTORIST LOCATION PRIOR TO IMPACT <input type="checkbox"/> 01 - INTERSECTION - MARKED CROSSWALK <input type="checkbox"/> 02 - INTERSECTION - NO CROSSWALK <input type="checkbox"/> 03 - INTERSECTION - OTHER <input type="checkbox"/> 04 - MIDBLOCK - MARKED CROSSWALK <input type="checkbox"/> 05 - TRAVEL LANE - OTHER LOCATION <input type="checkbox"/> 06 - BICYCLE LANE <input type="checkbox"/> 07 - SHOULDER/ROADSIDE <input type="checkbox"/> 08 - SIDEWALK <input type="checkbox"/> 09 - MEDIAN/CROSSING ISLAND <input type="checkbox"/> 10 - DRIVEWAY ACCESS <input type="checkbox"/> 11 - SHARED-USE PATH OR TRAIL <input type="checkbox"/> 12 - NON-TRAFFICWAY AREA <input type="checkbox"/> 99 - OTHER/UNKNOWN		TYPE OF USE 1 1 - PERSONAL 2 - COMMERCIAL 3 - GOVERNMENT <input type="checkbox"/> IN EMERGENCY RESPONSE		UNIT TYPE 02 99 - UNKNOWN OR HIT / SKIP		<input type="checkbox"/> HAS HM PLACARD					
SPECIAL FUNCTION <input type="checkbox"/> 01 - NONE <input type="checkbox"/> 02 - TAXI <input type="checkbox"/> 03 - RENTAL TRUCK (OVER 10K LBS) <input type="checkbox"/> 04 - BUS - SCHOOL (PUBLIC OR PRIVATE) <input type="checkbox"/> 05 - BUS - TRANSIT <input type="checkbox"/> 06 - BUS - CHARTER <input type="checkbox"/> 07 - BUS - SHUTTLE <input type="checkbox"/> 08 - BUS - OTHER		<input type="checkbox"/> 09 - AMBULANCE <input type="checkbox"/> 10 - FIRE <input type="checkbox"/> 11 - HIGHWAY/MAINTENANCE <input type="checkbox"/> 12 - MILITARY <input type="checkbox"/> 13 - POLICE <input type="checkbox"/> 14 - PUBLIC UTILITY <input type="checkbox"/> 15 - OTHER GOVERNMENT <input type="checkbox"/> 16 - CONSTRUCTION EQUIP.		<input type="checkbox"/> 17 - FARM VEHICLE <input type="checkbox"/> 18 - FARM EQUIPMENT <input type="checkbox"/> 19 - MOTORHOME <input type="checkbox"/> 20 - GOLF CART <input type="checkbox"/> 21 - TRAIN <input type="checkbox"/> 22 - OTHER (EXPLAIN IN NARRATIVE)		MOST DAMAGED AREA 08 IMPACT AREA 08		<input type="checkbox"/> 01 - NONE <input type="checkbox"/> 02 - CENTER FRONT <input type="checkbox"/> 03 - RIGHT FRONT <input type="checkbox"/> 04 - RIGHT SIDE <input type="checkbox"/> 05 - RIGHT REAR <input type="checkbox"/> 06 - REAR CENTER <input type="checkbox"/> 07 - LEFT REAR		ACTION 4 1 - NON-CONTACT 2 - NON-COLLISION 3 - STRIKING 4 - STRUCK 5 - STRIKING/STRUCK 9 - UNKNOWN	
PRE-CRASH ACTIONS 10 MOTORIST 01 - STRAIGHT AHEAD 02 - BACKING 03 - CHANGING LANES 04 - OVERTAKING/PASSING 05 - MAKING RIGHT TURN 06 - MAKING LEFT TURN 99 - UNKNOWN											
CONTRIBUTING CIRCUMSTANCES PRIMARY 01 MOTORIST 01 - NONE 02 - FAILURE TO YIELD 03 - RAN RED LIGHT 04 - RAN STOP SIGN 05 - EXCEEDED SPEED LIMIT 06 - UNSAFE SPEED 07 - IMPROPER TURN 08 - LEFT OF CENTER 09 - FOLLOWED TOO CLOSELY/ACDA 10 - IMPROPER LANE CHANGE /PASSING/OFF ROAD 99 - UNKNOWN											
VEHICLE DEFECTS <input type="checkbox"/> 01 - TURN SIGNALS <input type="checkbox"/> 02 - HEAD LAMPS <input type="checkbox"/> 03 - TAIL LAMPS <input type="checkbox"/> 04 - BRAKES <input type="checkbox"/> 05 - STEERING <input type="checkbox"/> 06 - TIRE BLOWOUT <input type="checkbox"/> 07 - WORN OR SLICK TIRES <input type="checkbox"/> 08 - TRAILER EQUIPMENT DEFECTIVE <input type="checkbox"/> 09 - MOTOR TROUBLE <input type="checkbox"/> 10 - DISABLED FROM PRIOR ACCIDENT <input type="checkbox"/> 11 - OTHER DEFECTS											
SEQUENCE OF EVENTS 1 21 2 <input type="checkbox"/> 3 <input type="checkbox"/> 4 <input type="checkbox"/> 5 <input type="checkbox"/> 6 <input type="checkbox"/> FIRST HARMFUL EVENT 1 MOST HARMFUL EVENT 1 99 - UNKNOWN						NON-COLLISION EVENTS 01 - OVERTURN/ROLLOVER 02 - FIRE/EXPLOSION 03 - IMMERSION 04 - JACKKNIFE 05 - CARGO/EQUIPMENT LOSS OR SHIFT 06 - EQUIPMENT FAILURE (BLOWN TIRE, BRAKE FAILURE, ETC) 07 - SEPARATION OF UNITS 08 - RAN OFF ROAD RIGHT 09 - RAN OFF ROAD LEFT 10 - CROSS MEDIAN OR SUPPORT 11 - CROSS CENTER LINE OPPOSITE DIRECTION OF TRAVEL 12 - DOWNHILL RUNAWAY 13 - OTHER NON-COLLISION					
COLLISION WITH PERSON, VEHICLE OR OBJECT NOT FIXED 14 - PEDESTRIAN 15 - PEDALCYCLE 16 - RAILWAY VEHICLE (TRAIN, ENGINE) 17 - ANIMAL - FARM 18 - ANIMAL - DEER 19 - ANIMAL - OTHER 20 - MOTOR VEHICLE IN TRANSPORT 21 - PARKED MOTOR VEHICLE 22 - WORK ZONE MAINTENANCE EQUIPMENT 23 - STRUCK BY FALLING, SHIFTING CARGO OR ANYTHING SET IN MOTION BY A MOTOR VEHICLE 24 - OTHER MOVABLE OBJECT						COLLISION WITH FIXED OBJECT 25 - IMPACT ATTENUATOR/CRASH CUSHION 26 - BRIDGE OVERHEAD STRUCTURE 27 - BRIDGE PIER OR ABUTMENT 28 - BRIDGE PARAPET 29 - BRIDGE RAIL 30 - GUARDRAIL FACE 31 - GUARDRAIL END 32 - PORTABLE BARRIER 33 - MEDIAN CABLE BARRIER 34 - MEDIAN GUARDRAIL BARRIER 35 - MEDIAN CONCRETE BARRIER 36 - MEDIAN OTHER BARRIER 37 - TRAFFIC SIGN POST 38 - OVERHEAD SIGN POST 39 - LIGHT/LUMINARIES SUPPORT 40 - UTILITY POLE 41 - OTHER POST, POLE OR SUPPORT 42 - CULVERT 43 - CURB 44 - DITCH 45 - EMBANKMENT 46 - FENCE 47 - MAILBOX 48 - TREE 49 - FIRE HYDRANT 50 - WORK ZONE MAINTENANCE EQUIPMENT 51 - WALL, BUILDING, TUNNEL 52 - OTHER FIXED OBJECT					
UNIT SPEED 0		POSTED SPEED 25		TRAFFIC CONTROL 01 01 - NO CONTROLS 02 - STOP SIGN 03 - YIELD SIGN 04 - TRAFFIC SIGNAL 05 - TRAFFIC FLASHERS 06 - SCHOOL ZONE 07 - RAILROAD CROSSBUCKS 08 - RAILROAD FLASHERS 09 - RAILROAD GATES 10 - CONSTRUCTION BARRICADE 11 - PERSON (FLAGGER, OFFICER) 12 - PAVEMENT MARKINGS 13 - CROSSWALK LINES 14 - WALK/DON'T WALK 15 - OTHER 16 - NOT REPORTED		UNIT DIRECTION FROM <input type="checkbox"/> TO <input type="checkbox"/> 1 - NORTH 2 - SOUTH 3 - EAST 4 - WEST 5 - NORTHEAST 6 - NORTHWEST 7 - SOUTHEAST 8 - SOUTHWEST 9 - UNKNOWN					



MOTORIST / Non-MOTORIST / OCCUPANT

LOCAL REPORT NUMBER

2018-00009415

Motorist/Non-Motorist

Motorist/Non-Motorist

OCCUPANT

OCCUPANT

UNIT NUMBER 01	NAME: LAST, FIRST, MIDDLE UNKNOWN, 01, 2018-00009415	DATE OF BIRTH	AGE	GENDER F - FEMALE M - MALE
--------------------------	--	---------------	-----	----------------------------------

ADDRESS, CITY, STATE, ZIP			CONTACT PHONE- INCLUDE AREA CODE	
---------------------------	--	--	----------------------------------	--

INJURIES	INJURED TAKEN BY	EMS AGENCY	MEDICAL FACILITY INJURED TAKEN TO	SAFETY EQUIPMENT USED	DOT COMPLIANT MOTORCYCLE HELMET	SEATING POSITION	AIR BAG USAGE	EJECTION	TRAPPED
----------	------------------	------------	-----------------------------------	-----------------------	---------------------------------------	------------------	---------------	----------	---------

OL STATE	OPERATOR LICENSE NUMBER	OL CLASS	No VALID OL	M/C END.	CONDITION	ALCOHOL/DRUG SUSPECTED	ALCOHOL TEST STATUS	ALCOHOL TEST TYPE	ALCOHOL TEST VALUE	DRUG TEST STATUS	DRUG TEST TYPE
----------	-------------------------	----------	-------------------	-------------	-----------	------------------------	---------------------	-------------------	--------------------	------------------	----------------

OFFENSE CHARGED (<input type="checkbox"/> LOCAL CODE)	OFFENSE DESCRIPTION	CITATION NUMBER	HANDS-FREE DEVICE USED	DRIVER DISTRACTED BY
---	---------------------	-----------------	------------------------------	----------------------

UNIT NUMBER 02	NAME: LAST, FIRST, MIDDLE PARKED, 2018-00009415	DATE OF BIRTH	AGE	GENDER F - FEMALE M - MALE
--------------------------	---	---------------	-----	----------------------------------

ADDRESS, CITY, STATE, ZIP 457 OLD PARIS RD ,WEST TERRE HAUTE ,IN			CONTACT PHONE- INCLUDE AREA CODE 812-841-7837	
--	--	--	---	--

INJURIES 1	INJURED TAKEN BY	EMS AGENCY	MEDICAL FACILITY INJURED TAKEN TO	SAFETY EQUIPMENT USED	DOT COMPLIANT MOTORCYCLE HELMET	SEATING POSITION	AIR BAG USAGE 1	EJECTION	TRAPPED
----------------------	------------------	------------	-----------------------------------	-----------------------	---------------------------------------	------------------	---------------------------	----------	---------

OL STATE IN	OPERATOR LICENSE NUMBER 8950079761	OL CLASS 4	No VALID OL	M/C END.	CONDITION	ALCOHOL/DRUG SUSPECTED	ALCOHOL TEST STATUS	ALCOHOL TEST TYPE	ALCOHOL TEST VALUE	DRUG TEST STATUS	DRUG TEST TYPE
-----------------------	--	----------------------	-------------------	-------------	-----------	------------------------	---------------------	-------------------	--------------------	------------------	----------------

OFFENSE CHARGED (<input type="checkbox"/> LOCAL CODE)	OFFENSE DESCRIPTION	CITATION NUMBER	HANDS-FREE DEVICE USED	DRIVER DISTRACTED BY 1
---	---------------------	-----------------	------------------------------	----------------------------------

INJURIES 1 - NO INJURY / NONE REPORTED 2 - POSSIBLE 3 - NON-INCAPACITATING 4 - INCAPACITATING 5 - FATAL	INJURED TAKEN BY 1 - NOT TRANSPORTED / TREATED AT SCENE 2 - EMS 3 - POLICE 4 - OTHER 9 - UNKNOWN	SAFETY EQUIPMENT USED MOTORIST 01 - NONE USED - VEHICLE OCCUPANT 02 - SHOULDER BELT ONLY USED 03 - LAP BELT ONLY USED 04 - SHOULDER AND LAP BELT USED	99 - UNKNOWN SAFETY EQUIPMENT MOTORIST 05 - CHILD RESTRAINT SYSTEM-FORWARD FACING 06 - CHILD RESTRAINT SYSTEM- REAR FACING 07 - BOOSTER SEAT 08 - HELMET USED	NON-MOTORIST 09 - NONE USED 10 - HELMET USED 11 - PROTECTIVE PADS USED (ELBOWS, KNEES, ETC)	12 - REFLECTIVE CLOTHING 13 - LIGHTING 14 - OTHER
--	---	--	--	--	---

SEATING POSITION 01 - FRONT - LEFT SIDE (MOTORCYCLE DRIVER) 02 - FRONT - MIDDLE 03 - FRONT - RIGHT SIDE 04 - SECOND - LEFT SIDE (MOTORCYCLE PASSENGER) 05 - SECOND - MIDDLE 06 - SECOND - RIGHT SIDE	07 - THIRD - LEFT SIDE (MOTORCYCLE SIDE CAR) 08 - THIRD - MIDDLE 09 - THIRD - RIGHT SIDE 10 - SLEEPER SECTION OF CAB (TRUCK) 11 - PASSENGER IN OTHER ENCLOSED CARGO AREA (NON-TRAILING UNIT SUCH AS A BUS, PICK-UP WITH CAP)	12 - PASSENGER IN UNENCLOSED CARGO AREA 13 - TRAILING UNIT 14 - RIDING ON VEHICLE EXTERIOR (NON-TRAILING UNIT) 15 - NON-MOTORIST 16 - OTHER 99 - UNKNOWN	AIR BAG USAGE 1 - NOT DEPLOYED 2 - DEPLOYED FRONT 3 - DEPLOYED SIDE 4 - DEPLOYED BOTH FRONT/SIDE 5 - NOT APPLICABLE 9 - DEPLOYMENT UNKNOWN
--	--	---	--

EJECTION 1 - NOT EJECTED 2 - TOTALLY EJECTED 3 - PARTIALLY EJECTED 4 - NOT APPLICABLE	TRAPPED 1 - NOT TRAPPED 2 - EXTRICATED BY MECHANICAL MEANS 3 - EXTRICATED BY NON-MECHANICAL MEANS	OPERATOR LICENSE CLASS 1 - CLASS A 2 - CLASS B 3 - CLASS C 4 - REGULAR CLASS (OHIO'S "D") 5 - MC/MOPED ONLY	CONDITION 1 - APPARENTLY NORMAL 2 - PHYSICAL IMPAIRMENT 3 - EMOTIONAL (DEPRESSED, ANGRY, DISTURBED) 4 - ILLNESS	5 - FELL ASLEEP, FAINTED, FATIGUED 6 - UNDER THE INFLUENCE OF MEDICATIONS, DRUGS, ALCOHOL 7 - OTHER	ALCOHOL/DRUG SUSPECTED 1 - NONE 2 - YES - ALCOHOL SUSPECTED 3 - YES - HBD NOT IMPAIRED 4 - YES - DRUGS SUSPECTED 5 - YES - ALCOHOL AND DRUGS SUSPECTED
---	--	--	---	---	---

ALCOHOL TEST STATUS 1 - NONE GIVEN 2 - TEST REFUSED 3 - TEST GIVEN, CONTAMINATED SAMPLE/UNUSABLE 4 - TEST GIVEN, RESULTS KNOWN 5 - TEST GIVEN, RESULTS UNKNOWN	ALCOHOL TEST TYPE 1 - NONE 2 - BLOOD 3 - URINE 4 - BREATH 5 - OTHER	DRUG TEST STATUS 1 - NONE GIVEN 2 - TEST REFUSED 3 - TEST GIVEN, CONTAMINATED SAMPLE/UNUSABLE 4 - TEST GIVEN, RESULTS KNOWN 5 - TEST GIVEN, RESULTS UNKNOWN	DRUG TEST TYPE 1 - NONE 2 - BLOOD 3 - URINE 4 - OTHER	DRIVER DISTRACTED BY 1 - NO DISTRACTION REPORTED 2 - PHONE 3 - TEXTING/E-MAILING 4 - ELECTRONIC COMMUNICATION DEVICE 5 - OTHER ELECTRONIC DEVICE (NAVIGATION DEVICE, RADIO, DVD)	6 - OTHER INSIDE THE VEHICLE 7 - EXTERNAL DISTRACTION
---	--	--	---	---	--

UNIT NUMBER	NAME: LAST, FIRST, MIDDLE	DATE OF BIRTH	AGE	GENDER F - FEMALE M - MALE
-------------	---------------------------	---------------	-----	----------------------------------

ADDRESS, CITY, STATE, ZIP			CONTACT PHONE- INCLUDE AREA CODE	
---------------------------	--	--	----------------------------------	--

INJURIES	INJURED TAKEN BY	EMS AGENCY	MEDICAL FACILITY INJURED TAKEN TO	SAFETY EQUIPMENT USED	DOT COMPLIANT MOTORCYCLE HELMET	SEATING POSITION	AIR BAG USAGE	EJECTION	TRAPPED
----------	------------------	------------	-----------------------------------	-----------------------	---------------------------------------	------------------	---------------	----------	---------

UNIT NUMBER	NAME: LAST, FIRST, MIDDLE	DATE OF BIRTH	AGE	GENDER F - FEMALE M - MALE
-------------	---------------------------	---------------	-----	----------------------------------

ADDRESS, CITY, STATE, ZIP			CONTACT PHONE- INCLUDE AREA CODE	
---------------------------	--	--	----------------------------------	--

INJURIES	INJURED TAKEN BY	EMS AGENCY	MEDICAL FACILITY INJURED TAKEN TO	SAFETY EQUIPMENT USED	DOT COMPLIANT MOTORCYCLE HELMET	SEATING POSITION	AIR BAG USAGE	EJECTION	TRAPPED
----------	------------------	------------	-----------------------------------	-----------------------	---------------------------------------	------------------	---------------	----------	---------