



TRAFFIC CRASH REPORT

LOCAL REPORT NUMBER *	CRASH SEVERITY	HIT/SKIP
2018-00021173	3 1 - FATAL 2 - INJURY 3 - PDO	2 1 - SOLVED 2 - UNSOLVED

LOCAL INFORMATION **18-21173**

<input type="checkbox"/> PHOTOS TAKEN <input type="checkbox"/> OH-2 <input type="checkbox"/> OH-1P <input type="checkbox"/> OH-3 <input type="checkbox"/> OTHER	<input type="checkbox"/> PDO UNDER STATE REPORTABLE DOLLAR AMOUNT	<input type="checkbox"/> PRIVATE PROPERTY	REPORTING AGENCY NCIC * 04501	REPORTING AGENCY NAME * Newark Police Department	NUMBER OF UNITS 02	UNIT IN ERROR 98 - ANIMAL 99 - UNKNOWN 02
---	---	---	---	--	------------------------------	---

COUNTY * 45	<input checked="" type="checkbox"/> CITY * <input type="checkbox"/> VILLAGE * <input type="checkbox"/> TOWNSHIP *	CITY, VILLAGE, TOWNSHIP * NEWARK	CRASH DATE * 07172018	TIME OF CRASH 2000	DAY OF WEEK Tue
-----------------------	---	--	---------------------------------	------------------------------	---------------------------

DEGREES / MINUTES / SECONDS LATITUDE 0 / / "	LONGITUDE 0 / / "	DECIMAL DEGREES LATITUDE 40.074905	LONGITUDE -8.240911
--	----------------------	---	-------------------------------

ROADWAY DIVISION <input type="checkbox"/> DIVIDED <input checked="" type="checkbox"/> UNDIVIDED	DIVIDED LANE DIRECTION OF TRAVEL N - NORTHBOUND E - EASTBOUND S - SOUTHBOUND W - WESTBOUND	NUMBER OF THRU LANES 01	ROAD TYPES OR MILEPOST ² AL - ALLEY CR - CIRCLE HE - HEIGHTS MP - MILEPOST PL - PLACE ST - STREET WA - WAY AV - AVENUE CT - COURT HW - HIGHWAY PK - PARKWAY RD - ROAD TE - TERRACE BL - BOULEVARD DR - DRIVE LA - LANE PI - PIKE SQ - SQUARE TL - TRAIL
---	--	-----------------------------------	---

LOCATION ROUTE NUMBER LOC PREFIX N,S,E,W LOCATION ROAD NAME PRIOR	LOCATION ROUTE TYPE 1	LOCATION ROAD TYPE 2 AV	ROUTE TYPES ¹ IR - INTERSTATE ROUTE (INC. TURNPIKE) CR - NUMBERED COUNTY ROUTE US - US ROUTE TR - NUMBERED TOWNSHIP ROUTE SR - STATE ROUTE
---	-----------------------	-----------------------------------	--

DISTANCE FROM REFERENCE <input type="checkbox"/> MILES <input type="checkbox"/> FEET <input type="checkbox"/> YARDS	DIR FROM REF N,S,E,W	REFERENCE ROUTE TYPE 1	REFERENCE ROUTE NUMBER	REF PREFIX N,S,E,W	REFERENCE NAME (ROAD, MILEPOST, HOUSE #) 581 PRIOR	REFERENCE ROAD TYPE 2 AV
--	----------------------	------------------------	------------------------	--------------------	--	------------------------------------

REFERENCE POINT USED 3 1 - INTERSECTION 2 - MILE POST 3 - HOUSE NUMBER	CRASH LOCATION 01 01 - NOT AN INTERSECTION 02 - FOUR-WAY INTERSECTION 03 - T-INTERSECTION 04 - Y-INTERSECTION 05 - TRAFFIC CIRCLE/ROUNDBOAT 06 - FIVE-POINT, OR MORE 07 - ON RAMP 08 - OFF RAMP 09 - CROSSOVER 10 - DRIVEWAY/ALLEY ACCESS 11 - RAILWAY GRADE CROSSING 12 - SHARED-USE PATHS OR TRAILS 99 - UNKNOWN	<input type="checkbox"/> INTERSECTION RELATED	LOCATION OF FIRST HARMFUL EVENT 5 1 - ON ROADWAY 2 - ON SHOULDER 3 - IN MEDIAN 4 - ON ROADSIDE 5 - ON GORE 6 - OUTSIDE TRAFFICWAY 9 - UNKNOWN
---	---	---	--

ROAD CONTOUR 1 1 - STRAIGHT LEVEL 2 - STRAIGHT GRADE 3 - CURVE LEVEL 4 - CURVE GRADE 9 - UNKNOWN	ROAD CONDITIONS PRIMARY 01 SECONDARY	01 - DRY 02 - WET 03 - SNOW 04 - ICE 05 - SAND, MUD, DIRT, OIL, GRAVEL 06 - WATER (STANDING, MOVING) 07 - SLUSH 08 - DEBRIS* 09 - RUT, HOLES, BUMPS, UNEVEN PAVEMENT* 10 - OTHER 99 - UNKNOWN	* SECONDARY CONDITION ONLY
---	--	---	----------------------------

MANNER OF CRASH COLLISION/IMPACT 9 1 - NOT COLLISION BETWEEN TWO MOTOR VEHICLES IN TRANSPORT 2 - REAR-END 3 - HEAD-ON 4 - REAR-TO-REAR 5 - BACKING 6 - ANGLE 7 - SIDESWIPE, SAME DIRECTION 8 - SIDESWIPE, OPPOSITE DIRECTION 9 - UNKNOWN	WEATHER 1 1 - CLEAR 2 - CLOUDY 3 - FOG, SMOG, SMOKE 4 - RAIN 5 - SLEET, HAIL 6 - SNOW 7 - SEVERE CROSSWINDS 8 - BLOWING SAND, SOIL, DIRT, SNOW 9 - OTHER/UNKNOWN
---	---

ROAD SURFACE 2 1 - CONCRETE 2 - BLACKTOP, BITUMINOUS, ASPHALT 3 - BRICK/BLOCK 4 - SLAG, GRAVEL, STONE 5 - DIRT 6 - OTHER	LIGHT CONDITIONS PRIMARY 3 SECONDARY	1 - DAYLIGHT 2 - DAWN 3 - DUSK 4 - DARK - LIGHTED ROADWAY 5 - DARK - ROADWAY NOT LIGHTED 6 - DARK - UNKNOWN ROADWAY LIGHTING 7 - GLARE* 8 - OTHER 9 - UNKNOWN	<input type="checkbox"/> SCHOOL ZONE RELATED <input type="checkbox"/> YES, SCHOOL BUS DIRECTLY INVOLVED <input type="checkbox"/> YES, SCHOOL BUS INDIRECTLY INVOLVED
--	--	---	--

<input type="checkbox"/> WORK ZONE RELATED <input type="checkbox"/> WORKERS PRESENT <input type="checkbox"/> LAW ENFORCEMENT PRESENT (OFFICER/VEHICLE) <input type="checkbox"/> LAW ENFORCEMENT PRESENT (VEHICLE ONLY)	TYPE OF WORK ZONE <input type="checkbox"/> 1 - LANE CLOSURE 2 - LANE SHIFT/CROSSOVER 3 - WORK ON SHOULDER OR MEDIAN 4 - INTERMITTENT OR MOVING WORK 5 - OTHER	LOCATION OF CRASH IN WORK ZONE <input type="checkbox"/> 1 - BEFORE THE FIRST WORK ZONE WARNING SIGN 2 - ADVANCE WARNING AREA 3 - TRANSITION AREA 4 - ACTIVITY AREA 5 - TERMINATION AREA
---	---	---

NARRATIVE
UNIT #1 WAS PARKED S/B. UNIT #2 STRUCK UNIT #1 THEN FLED.

UNIT #2 DIRECTION DURING ACCIDENT IS NOT KNOWN.

Diagram

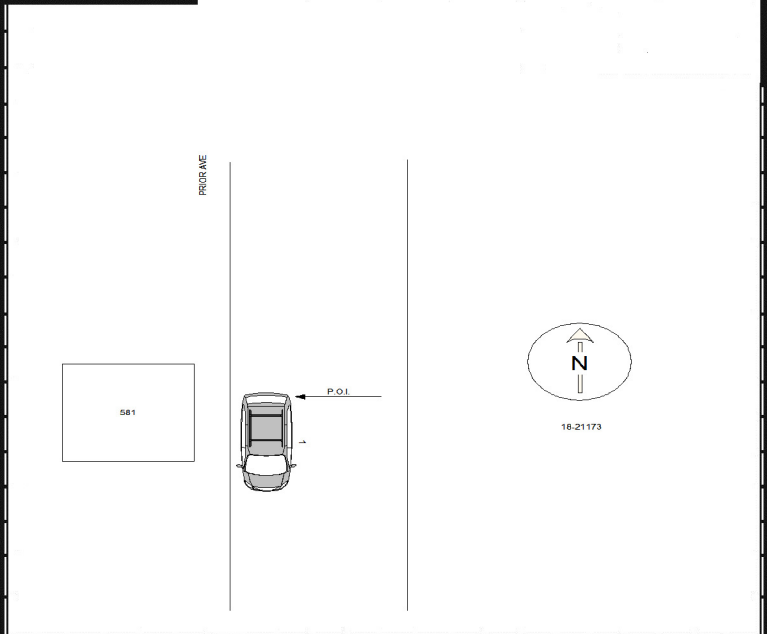

REPORT TAKEN BY <input checked="" type="checkbox"/> POLICE AGENCY <input type="checkbox"/> MOTORIST	<input type="checkbox"/> SUPPLEMENT (CORRECTION OR ADDITION TO AN EXISTING REPORT SENT TO ODPS)
--	---

DATE CRASH REPORTED 07172018	TIME CRASH REPORTED 2000	DISPATCH TIME 2109	ARRIVAL TIME 2120	TIME CLEARED 2157	OTHER INVESTIGATION TIME	TOTAL MINUTES 48
--	------------------------------------	------------------------------	-----------------------------	-----------------------------	--------------------------	----------------------------

OFFICER'S NAME * Palmisano, Phil	OFFICER'S BADGE NUMBER 45NPD-339	CHECKED BY Schmidt, Melissa	PAGE 1 OF 4
--	--	---------------------------------------	---------------------------



UNIT

LOCAL REPORT NUMBER

2018-00021173

UNIT NUMBER 01		OWNER NAME: LAST, FIRST, MIDDLE (<input type="checkbox"/> SAME AS DRIVER) HOWILER, JEFFREY, A		OWNER PHONE NUMBER - INC. AREA CODE (<input type="checkbox"/> SAME AS DRIVER) 740-258-0449		DAMAGE SCALE 2	DAMAGED AREA 		
OWNER ADDRESS: CITY, STATE, ZIP (<input checked="" type="checkbox"/> SAME AS DRIVER) 581 PRIOR AVE, OH 43055									
LP STATE OH		LICENSE PLATE NUMBER HHR4323		VEHICLE IDENTIFICATION NUMBER 2C4RDJGCG5ER320148		# OCCUPANTS 1			
VEHICLE YEAR 2014		VEHICLE MAKE Dodge		VEHICLE MODEL CARAVAN		VEHICLE COLOR			
<input type="checkbox"/> PROOF OF INSURANCE SHOWN		INSURANCE COMPANY safeco insurance		POLICY NUMBER OK6660149		TOWED BY			
CARRIER NAME, ADDRESS, CITY, STATE, ZIP							CARRIER PHONE - INCLUDE AREA CODE		
US DOT		VEHICLE WEIGHT GVWR/GCWR <input type="checkbox"/> 1 - LESS THAN OR EQUAL TO 10K LBS. <input type="checkbox"/> 2 - 10,001 TO 26,000 LBS. <input type="checkbox"/> 3 - MORE THAN 26,000 LBS.		CARGO BODY TYPE <input type="checkbox"/> 01 - No CARGO BODY TYPE/NOT APPLICABLE <input type="checkbox"/> 02 - BUS/VAN (9-15 SEATS, INC DRIVER) <input type="checkbox"/> 03 - BUS (16+ SEATS, INC DRIVER) <input type="checkbox"/> 04 - VEHICLE TOWING ANOTHER VEHICLE <input type="checkbox"/> 05 - LOGGING <input type="checkbox"/> 06 - INTERMODAL CONTAINER CHASSIS <input type="checkbox"/> 07 - CARGO VAN/ENCLOSED BOX <input type="checkbox"/> 08 - GRAIN, CHIPS, GRAVEL		TRAFFICWAY DESCRIPTION 1 1 - Two-Way, NOT DIVIDED 2 - Two-Way, NOT DIVIDED, CONTINUOUS LEFT TURN LANE 3 - Two-Way, DIVIDED, UNPROTECTED (PAINTED OR GRASS >4 FT) MEDIAN 4 - Two-Way, DIVIDED, POSITIVE MEDIAN BARRIER 5 - One-Way TRAFFICWAY			
HM PLACARD ID No.		<input type="checkbox"/> HAZARDOUS MATERIAL RELEASED		PASSENGER VEHICLES (LESS THAN 9 PASSENGERS) 01 - SUB-COMPACT 02 - COMPACT 03 - MID SIZE 04 - FULL SIZE 05 - MINIVAN 06 - SPORT UTILITY VEHICLE 07 - PICKUP 08 - VAN 09 - MOTORCYCLE 10 - MOTORIZED BICYCLE 11 - SNOWMOBILE/ATV 12 - OTHER PASSENGER VEHICLE		<input type="checkbox"/> HIT / SKIP UNIT			
HM CLASS NUMBER		TYPE OF USE 1 1 - PERSONAL 2 - COMMERCIAL 3 - GOVERNMENT <input type="checkbox"/> IN EMERGENCY RESPONSE		UNIT TYPE 05 99 - UNKNOWN OR HIT / SKIP		MED/HEAVY TRUCKS OR COMBO UNITS > 10K LBS 13 - SINGLE UNIT TRUCK OR VAN 2AXLE, 6 TIRES 14 - SINGLE UNIT TRUCK; 3+ AXLES 15 - SINGLE UNIT TRUCK / TRAILER 16 - TRUCK/TRACTOR (BOBTAIL) 17 - TRACTOR/SEMI-TRAILER 18 - TRACTOR/DOUBLE 19 - TRACTOR/TRIPLES 20 - OTHER MED/HEAVY VEHICLE			
NON-MOTORIST LOCATION PRIOR TO IMPACT <input type="checkbox"/> 01 - INTERSECTION - MARKED CROSSWALK <input type="checkbox"/> 02 - INTERSECTION - NO CROSSWALK <input type="checkbox"/> 03 - INTERSECTION - OTHER <input type="checkbox"/> 04 - MIDBLOCK - MARKED CROSSWALK <input type="checkbox"/> 05 - TRAVEL LANE - OTHER LOCATION <input type="checkbox"/> 06 - BICYCLE LANE <input type="checkbox"/> 07 - SHOULDER/ROADSIDE <input type="checkbox"/> 08 - SIDEWALK <input type="checkbox"/> 09 - MEDIAN/CROSSING ISLAND <input type="checkbox"/> 10 - DRIVEWAY ACCESS <input type="checkbox"/> 11 - SHARED-USE PATH OR TRAIL <input type="checkbox"/> 12 - NON-TRAFFICWAY AREA <input type="checkbox"/> 99 - OTHER/UNKNOWN		SPECIAL FUNCTION <input type="checkbox"/> 01 - NONE <input type="checkbox"/> 02 - TAXI <input type="checkbox"/> 03 - RENTAL TRUCK (OVER 10K LBS) <input type="checkbox"/> 04 - BUS - SCHOOL (PUBLIC OR PRIVATE) <input type="checkbox"/> 05 - BUS - TRANSIT <input type="checkbox"/> 06 - BUS - CHARTER <input type="checkbox"/> 07 - BUS - SHUTTLE <input type="checkbox"/> 08 - BUS - OTHER		17 - FARM VEHICLE 18 - FARM EQUIPMENT 19 - MOTORHOME 20 - GOLF CART 21 - TRAIN 22 - OTHER (EXPLAIN IN NARRATIVE)		MOST DAMAGED AREA 07 01 - NONE 02 - CENTER FRONT 03 - RIGHT FRONT 04 - RIGHT SIDE 05 - RIGHT REAR 06 - REAR CENTER 07 - LEFT REAR		ACTION 4 1 - NON-CONTACT 2 - NON-COLLISION 3 - STRIKING 4 - STRUCK 5 - STRIKING/STRUCK 9 - UNKNOWN	
PRE-CRASH ACTIONS 10		MOTORIST 01 - STRAIGHT AHEAD 02 - BACKING 03 - CHANGING LANES 04 - OVERTAKING/PASSING 05 - MAKING RIGHT TURN 06 - MAKING LEFT TURN 99 - UNKNOWN		07 - MAKING U-TURN 08 - ENTERING TRAFFIC LANE 09 - LEAVING TRAFFIC LANE 10 - PARKED 11 - SLOWING OR STOPPED IN TRAFFIC 12 - DRIVERLESS		NON-MOTORIST 13 - NEGOTIATING A CURVE 14 - OTHER MOTORIST ACTION 15 - ENTERING OR CROSSING SPECIFIED LOCATION 16 - WALKING, RUNNING, JOGGING, PLAYING, CYCLING 17 - WORKING 18 - PUSHING VEHICLE 19 - APPROACHING OR LEAVING VEHICLE 20 - STANDING		21 - OTHER NON-MOTORIST ACTION	
CONTRIBUTING CIRCUMSTANCES PRIMARY <input type="checkbox"/>		MOTORIST 01 - NONE 02 - FAILURE TO YIELD 03 - RAN RED LIGHT 04 - RAN STOP SIGN 05 - EXCEEDED SPEED LIMIT 06 - UNSAFE SPEED 07 - IMPROPER TURN 08 - LEFT OF CENTER 09 - FOLLOWED TOO CLOSELY/ACDA 10 - IMPROPER LANE CHANGE /PASSING/OFF ROAD		NON-MOTORIST 11 - IMPROPER BACKING 12 - IMPROPER START FROM PARKED POSITION 13 - STOPPED OR PARKED ILLEGALLY 14 - OPERATING VEHICLE IN NEGLIGENCE MANNER 15 - SWERVING TO AVOID (DUE TO EXTERNAL CONDITIONS) 16 - WRONG SIDE/WRONG WAY 17 - FAILURE TO CONTROL 18 - VISION OBSTRUCTION 19 - OPERATING DEFECTIVE EQUIPMENT 20 - LOAD SHIFTING/FALLING/SPILLING 21 - OTHER IMPROPER ACTION		VEHICLE DEFECTS <input type="checkbox"/> 01 - TURN SIGNALS 02 - HEAD LAMPS 03 - TAIL LAMPS 04 - BRAKES 05 - STEERING 06 - TIRE BLOWOUT 07 - WORN OR SLICK TIRES 08 - TRAILER EQUIPMENT DEFECTIVE 09 - MOTOR TROUBLE 10 - DISABLED FROM PRIOR ACCIDENT 11 - OTHER DEFECTS			
SEQUENCE OF EVENTS 1 <input type="checkbox"/> 2 <input type="checkbox"/> 3 <input type="checkbox"/> 4 <input type="checkbox"/> 5 <input type="checkbox"/> 6 <input type="checkbox"/> FIRST HARMFUL EVENT <input type="checkbox"/> MOST HARMFUL EVENT <input type="checkbox"/>		NON-COLLISION EVENTS 01 - OVERTURN/ROLLOVER 02 - FIRE/EXPLOSION 03 - IMMERSION 04 - JACKKNIFE 05 - CARGO/EQUIPMENT LOSS OR SHIFT 06 - EQUIPMENT FAILURE (BLOWN TIRE, BRAKE FAILURE, ETC) 07 - SEPARATION OF UNITS 08 - RAN OFF ROAD RIGHT 09 - RAN OFF ROAD LEFT		COLLISION WITH FIXED OBJECT 25 - IMPACT ATTENUATOR/CRASH CUSHION 26 - BRIDGE OVERHEAD STRUCTURE 27 - BRIDGE PIER OR ABUTMENT 28 - BRIDGE PARAPET 29 - BRIDGE RAIL 30 - GUARDRAIL FACE 31 - GUARDRAIL END 32 - PORTABLE BARRIER		10 - CROSS MEDIAN OR SUPPORT 11 - CROSS CENTER LINE OPPOSITE DIRECTION OF TRAVEL 12 - DOWNHILL RUNAWAY 13 - OTHER NON-COLLISION 33 - MEDIAN CABLE BARRIER 34 - MEDIAN GUARDRAIL BARRIER 35 - MEDIAN CONCRETE BARRIER 36 - MEDIAN OTHER BARRIER 37 - TRAFFIC SIGN POST 38 - OVERHEAD SIGN POST 39 - LIGHT/LUMINARIES SUPPORT 40 - UTILITY POLE		41 - OTHER POST, POLE OR SUPPORT 42 - CULVERT 43 - CURB 44 - DITCH 45 - EMBANKMENT 46 - FENCE 47 - MAILBOX 48 - TREE 49 - FIRE HYDRANT 50 - WORK ZONE MAINTENANCE EQUIPMENT 51 - WALL, BUILDING, TUNNEL 52 - OTHER FIXED OBJECT	
COLLISION WITH PERSON, VEHICLE OR OBJECT NOT FIXED 14 - PEDESTRIAN 15 - PEDALCYCLE 16 - RAILWAY VEHICLE (TRAIN, ENGINE) 17 - ANIMAL - FARM 18 - ANIMAL - DEER 19 - ANIMAL - OTHER 20 - MOTOR VEHICLE IN TRANSPORT		21 - PARKED MOTOR VEHICLE 22 - WORK ZONE MAINTENANCE EQUIPMENT 23 - STRUCK BY FALLING, SHIFTING CARGO OR ANYTHING SET IN MOTION BY A MOTOR VEHICLE 24 - OTHER MOVABLE OBJECT		UNIT SPEED <input type="checkbox"/> STATED <input type="checkbox"/> ESTIMATED		POSTED SPEED <input type="checkbox"/>		TRAFFIC CONTROL <input type="checkbox"/> 01 - NO CONTROLS 02 - STOP SIGN 03 - YIELD SIGN 04 - TRAFFIC SIGNAL 05 - TRAFFIC FLASHERS 06 - SCHOOL ZONE	
UNIT DIRECTION FROM N TO S		07 - RAILROAD CROSSBUCKS 08 - RAILROAD FLASHERS 09 - RAILROAD GATES 10 - CONSTRUCTION BARRICADE 11 - PERSON (FLAGGER, OFFICER) 12 - PAVEMENT MARKINGS		13 - CROSSWALK LINES 14 - WALK/DON'T WALK 15 - OTHER 16 - NOT REPORTED		1 - NORTH 2 - SOUTH 3 - EAST 4 - WEST		5 - NORTHEAST 6 - NORTHWEST 7 - SOUTHEAST 8 - SOUTHWEST 9 - UNKNOWN	



UNIT

LOCAL REPORT NUMBER

2018-00021173

UNIT NUMBER 02		OWNER NAME: LAST, FIRST, MIDDLE (<input type="checkbox"/> SAME AS DRIVER)		OWNER PHONE NUMBER - INC. AREA CODE (<input type="checkbox"/> SAME AS DRIVER)		DAMAGE SCALE <input type="checkbox"/> 1 - NONE <input type="checkbox"/> 2 - MINOR <input type="checkbox"/> 3 - FUNCTIONAL <input type="checkbox"/> 4 - DISABLING <input type="checkbox"/> 9 - UNKNOWN	DAMAGED AREA 		
OWNER ADDRESS: CITY, STATE, ZIP (<input type="checkbox"/> SAME AS DRIVER)									
LP STATE		LICENSE PLATE NUMBER		VEHICLE IDENTIFICATION NUMBER		# OCCUPANTS			
VEHICLE YEAR		VEHICLE MAKE		VEHICLE MODEL		VEHICLE COLOR			
<input type="checkbox"/> PROOF OF INSURANCE SHOWN		INSURANCE COMPANY		POLICY NUMBER		TOWED BY			
CARRIER NAME, ADDRESS, CITY, STATE, ZIP							CARRIER PHONE - INCLUDE AREA CODE		
US DOT		VEHICLE WEIGHT GVWR/GCWR 1 - LESS THAN OR EQUAL TO 10K LBS. 2 - 10,001 TO 26,000 LBS. 3 - MORE THAN 26,000 LBS.		CARGO BODY TYPE <input type="checkbox"/> 01 - NO CARGO BODY TYPE/NOT APPLICABLE <input type="checkbox"/> 02 - BUS/VAN (9-15 SEATS, INC DRIVER) <input type="checkbox"/> 03 - BUS (16+ SEATS, INC DRIVER) <input type="checkbox"/> 04 - VEHICLE TOWING ANOTHER VEHICLE <input type="checkbox"/> 05 - LOGGING <input type="checkbox"/> 06 - INTERMODAL CONTAINER CHASSIS <input type="checkbox"/> 07 - CARGO VAN/ENCLOSED BOX <input type="checkbox"/> 08 - GRAIN, CHIPS, GRAVEL		TRAFFICWAY DESCRIPTION <input type="checkbox"/> 1 - TWO-WAY, NOT DIVIDED <input type="checkbox"/> 2 - TWO-WAY, NOT DIVIDED, CONTINUOUS LEFT TURN LANE <input type="checkbox"/> 3 - TWO-WAY, DIVIDED, UNPROTECTED (PAINTED OR GRASS >4FT) MEDIAN <input type="checkbox"/> 4 - TWO-WAY, DIVIDED, POSITIVE MEDIAN BARRIER <input type="checkbox"/> 5 - ONE-WAY TRAFFICWAY <input checked="" type="checkbox"/> HIT / SKIP UNIT			
HM PLACARD ID NO.		<input type="checkbox"/> HAZARDOUS MATERIAL RELEASED		HM CLASS NUMBER					
NON-MOTORIST LOCATION PRIOR TO IMPACT <input type="checkbox"/> 01 - INTERSECTION - MARKED CROSSWALK <input type="checkbox"/> 02 - INTERSECTION - NO CROSSWALK <input type="checkbox"/> 03 - INTERSECTION - OTHER <input type="checkbox"/> 04 - MIDBLOCK - MARKED CROSSWALK <input type="checkbox"/> 05 - TRAVEL LANE - OTHER LOCATION <input type="checkbox"/> 06 - BICYCLE LANE <input type="checkbox"/> 07 - SHOULDER/ROADSIDE <input type="checkbox"/> 08 - SIDEWALK <input type="checkbox"/> 09 - MEDIAN/CROSSING ISLAND <input type="checkbox"/> 10 - DRIVEWAY ACCESS <input type="checkbox"/> 11 - SHARED-USE PATH OR TRAIL <input type="checkbox"/> 12 - NON-TRAFFICWAY AREA <input type="checkbox"/> 99 - OTHER/UNKNOWN		TYPE OF USE <input type="checkbox"/> 1 - PERSONAL <input type="checkbox"/> 2 - COMMERCIAL <input type="checkbox"/> 3 - GOVERNMENT <input type="checkbox"/> IN EMERGENCY RESPONSE		UNIT TYPE 99 99 - UNKNOWN OR HIT / SKIP		PASSENGER VEHICLES (LESS THAN 9 PASSENGERS) 01 - SUB-COMPACT 02 - COMPACT 03 - MID SIZE 04 - FULL SIZE 05 - MINIVAN 06 - SPORT UTILITY VEHICLE 07 - PICKUP 08 - VAN 09 - MOTORCYCLE 10 - MOTORIZED BICYCLE 11 - SNOWMOBILE/ATV 12 - OTHER PASSENGER VEHICLE			
SPECIAL FUNCTION <input type="checkbox"/> 01 - NONE <input type="checkbox"/> 02 - TAXI <input type="checkbox"/> 03 - RENTAL TRUCK (OVER 10K LBS) <input type="checkbox"/> 04 - BUS - SCHOOL (PUBLIC OR PRIVATE) <input type="checkbox"/> 05 - BUS - TRANSIT <input type="checkbox"/> 06 - BUS - CHARTER <input type="checkbox"/> 07 - BUS - SHUTTLE <input type="checkbox"/> 08 - BUS - OTHER		<input type="checkbox"/> 09 - AMBULANCE <input type="checkbox"/> 10 - FIRE <input type="checkbox"/> 11 - HIGHWAY/MAINTENANCE <input type="checkbox"/> 12 - MILITARY <input type="checkbox"/> 13 - POLICE <input type="checkbox"/> 14 - PUBLIC UTILITY <input type="checkbox"/> 15 - OTHER GOVERNMENT <input type="checkbox"/> 16 - CONSTRUCTION EQUIP.		<input type="checkbox"/> 17 - FARM VEHICLE <input type="checkbox"/> 18 - FARM EQUIPMENT <input type="checkbox"/> 19 - MOTORHOME <input type="checkbox"/> 20 - GOLF CART <input type="checkbox"/> 21 - TRAIN <input type="checkbox"/> 22 - OTHER (EXPLAIN IN NARRATIVE)		MOST DAMAGED AREA <input type="checkbox"/> 01 - NONE <input type="checkbox"/> 02 - CENTER FRONT <input type="checkbox"/> 03 - RIGHT FRONT <input type="checkbox"/> 04 - RIGHT SIDE <input type="checkbox"/> 05 - RIGHT REAR <input type="checkbox"/> 06 - REAR CENTER <input type="checkbox"/> 07 - LEFT REAR		IMPACT AREA <input type="checkbox"/> 08 - LEFT SIDE <input type="checkbox"/> 09 - LEFT FRONT <input type="checkbox"/> 10 - TOP AND WINDOWS <input type="checkbox"/> 11 - UNDERCARRIAGE <input type="checkbox"/> 12 - LOAD/TRAILER <input type="checkbox"/> 13 - TOTAL(ALL AREAS) <input type="checkbox"/> 14 - OTHER	
PRE-CRASH ACTIONS <input type="checkbox"/> 99 - UNKNOWN		MOTORIST 01 - STRAIGHT AHEAD 02 - BACKING 03 - CHANGING LANES 04 - OVERTAKING/PASSING 05 - MAKING RIGHT TURN 06 - MAKING LEFT TURN		07 - MAKING U-TURN 08 - ENTERING TRAFFIC LANE 09 - LEAVING TRAFFIC LANE 10 - PARKED 11 - SLOWING OR STOPPED IN TRAFFIC 12 - DRIVERLESS		13 - NEGOTIATING A CURVE 14 - OTHER MOTORIST ACTION		NON-MOTORIST 15 - ENTERING OR CROSSING SPECIFIED LOCATION 16 - WALKING, RUNNING, JOGGING, PLAYING, CYCLING 17 - WORKING 18 - PUSHING VEHICLE 19 - APPROACHING OR LEAVING VEHICLE 20 - STANDING	
CONTRIBUTING CIRCUMSTANCES PRIMARY <input type="checkbox"/> 99 - UNKNOWN		MOTORIST 01 - NONE 02 - FAILURE TO YIELD 03 - RAN RED LIGHT 04 - RAN STOP SIGN 05 - EXCEEDED SPEED LIMIT 06 - UNSAFE SPEED 07 - IMPROPER TURN 08 - LEFT OF CENTER 09 - FOLLOWED TOO CLOSELY/ACDA 10 - IMPROPER LANE CHANGE /PASSING/OFF ROAD		NON-MOTORIST 11 - IMPROPER BACKING 12 - IMPROPER START FROM PARKED POSITION 13 - STOPPED OR PARKED ILLEGALLY 14 - OPERATING VEHICLE IN NEGLIGENCE MANNER 15 - SWERVING TO AVOID (DUE TO EXTERNAL CONDITIONS) 16 - WRONG SIDE/WRONG WAY 17 - FAILURE TO CONTROL 18 - VISION OBSTRUCTION 19 - OPERATING DEFECTIVE EQUIPMENT 20 - LOAD SHIFTING/FALLING/SPILLING 21 - OTHER IMPROPER ACTION		VEHICLE DEFECTS <input type="checkbox"/> 01 - TURN SIGNALS <input type="checkbox"/> 02 - HEAD LAMPS <input type="checkbox"/> 03 - TAIL LAMPS <input type="checkbox"/> 04 - BRAKES <input type="checkbox"/> 05 - STEERING <input type="checkbox"/> 06 - TIRE BLOWOUT <input type="checkbox"/> 07 - WORN OR SLICK TIRES <input type="checkbox"/> 08 - TRAILER EQUIPMENT DEFECTIVE <input type="checkbox"/> 09 - MOTOR TROUBLE <input type="checkbox"/> 10 - DISABLED FROM PRIOR ACCIDENT <input type="checkbox"/> 11 - OTHER DEFECTS			
SEQUENCE OF EVENTS 1 <input type="checkbox"/> 2 <input type="checkbox"/> 3 <input type="checkbox"/> 4 <input type="checkbox"/> 5 <input type="checkbox"/> 6 <input type="checkbox"/> FIRST HARMFUL EVENT <input type="checkbox"/> MOST HARMFUL EVENT <input type="checkbox"/>		NON-COLLISION EVENTS 01 - OVERTURN/ROLLOVER 02 - FIRE/EXPLOSION 03 - IMMERSION 04 - JACKKNIFE 05 - CARGO/EQUIPMENT LOSS OR SHIFT 06 - EQUIPMENT FAILURE (BLOWN TIRE, BRAKE FAILURE, ETC) 07 - SEPARATION OF UNITS 08 - RAN OFF ROAD RIGHT 09 - RAN OFF ROAD LEFT		10 - CROSS MEDIAN OR SUPPORT 11 - CROSS CENTER LINE OPPOSITE DIRECTION OF TRAVEL 12 - DOWNHILL RUNAWAY 13 - OTHER NON-COLLISION		COLLISION WITH FIXED OBJECT 25 - IMPACT ATTENUATOR/CRASH CUSHION 26 - BRIDGE OVERHEAD STRUCTURE 27 - BRIDGE PIER OR ABUTMENT 28 - BRIDGE PARAPET 29 - BRIDGE RAIL 30 - GUARDRAIL FACE 31 - GUARDRAIL END 32 - PORTABLE BARRIER		33 - MEDIAN CABLE BARRIER 34 - MEDIAN GUARDRAIL BARRIER 35 - MEDIAN CONCRETE BARRIER 36 - MEDIAN OTHER BARRIER 37 - TRAFFIC SIGN POST 38 - OVERHEAD SIGN POST 39 - LIGHT/LUMINARIES SUPPORT 40 - UTILITY POLE	
COLLISION WITH PERSON, VEHICLE OR OBJECT NOT FIXED 14 - PEDESTRIAN 15 - PEDALCYCLE 16 - RAILWAY VEHICLE (TRAIN, ENGINE) 17 - ANIMAL - FARM 18 - ANIMAL - DEER 19 - ANIMAL - OTHER 20 - MOTOR VEHICLE IN TRANSPORT		21 - PARKED MOTOR VEHICLE 22 - WORK ZONE MAINTENANCE EQUIPMENT 23 - STRUCK BY FALLING, SHIFTING CARGO OR ANYTHING SET IN MOTION BY A MOTOR VEHICLE 24 - OTHER MOVABLE OBJECT		41 - OTHER POST, POLE OR SUPPORT 42 - CULVERT 43 - CURB 44 - DITCH 45 - EMBANKMENT 46 - FENCE 47 - MAILBOX		48 - TREE 49 - FIRE HYDRANT 50 - WORK ZONE MAINTENANCE EQUIPMENT 51 - WALL, BUILDING, TUNNEL 52 - OTHER FIXED OBJECT			
UNIT SPEED <input type="checkbox"/> STATED <input type="checkbox"/> ESTIMATED		POSTED SPEED		TRAFFIC CONTROL <input type="checkbox"/> 01 - NO CONTROLS <input type="checkbox"/> 02 - STOP SIGN <input type="checkbox"/> 03 - YIELD SIGN <input type="checkbox"/> 04 - TRAFFIC SIGNAL <input type="checkbox"/> 05 - TRAFFIC FLASHERS <input type="checkbox"/> 06 - SCHOOL ZONE		07 - RAILROAD CROSSBUCKS 08 - RAILROAD FLASHERS 09 - RAILROAD GATES 10 - CONSTRUCTION BARRICADE 11 - PERSON (FLAGGER, OFFICER) 12 - PAVEMENT MARKINGS		UNIT DIRECTION FROM <input type="checkbox"/> TO <input type="checkbox"/> 1 - NORTH 2 - SOUTH 3 - EAST 4 - WEST	
5 - NORTHEAST 6 - NORTHWEST 7 - SOUTHEAST 8 - SOUTHWEST		9 - UNKNOWN							



MOTORIST / Non-MOTORIST / OCCUPANT

LOCAL REPORT NUMBER
2018-00021173

Motorist/Non-Motorist

Motorist/Non-Motorist

Occupant

UNIT NUMBER 01	NAME: LAST, FIRST, MIDDLE PARKED, 2018-00021173, A	DATE OF BIRTH 04141986	AGE 032	GENDER <input type="checkbox"/> F - FEMALE <input type="checkbox"/> M - MALE
--------------------------	--	----------------------------------	-------------------	--

ADDRESS, CITY, STATE, ZIP 581 PRIOR AVE ,OH 43055	CONTACT PHONE- INCLUDE AREA CODE 740-777-2991
---	---

INJURIES <input type="checkbox"/>	INJURED TAKEN BY <input type="checkbox"/>	EMS AGENCY	MEDICAL FACILITY INJURED TAKEN TO	SAFETY EQUIPMENT USED <input type="checkbox"/>	DOT COMPLIANT MOTORCYCLE HELMET <input type="checkbox"/>	SEATING POSITION <input type="checkbox"/>	AIR BAG USAGE <input type="checkbox"/>	EJECTION <input type="checkbox"/>	TRAPPED <input type="checkbox"/>
--------------------------------------	--	------------	-----------------------------------	---	---	--	---	--------------------------------------	-------------------------------------

OL STATE OH	OPERATOR LICENSE NUMBER SM605323	OL CLASS <input type="checkbox"/>	No VALID OL <input type="checkbox"/>	M/C END. <input type="checkbox"/>	CONDITION <input type="checkbox"/>	ALCOHOL/DRUG SUSPECTED <input type="checkbox"/>	ALCOHOL TEST STATUS <input type="checkbox"/>	ALCOHOL TEST TYPE <input type="checkbox"/>	ALCOHOL TEST VALUE <input type="checkbox"/>	DRUG TEST STATUS <input type="checkbox"/>	DRUG TEST TYPE <input type="checkbox"/>
-----------------------	--	--------------------------------------	---	--------------------------------------	---------------------------------------	--	---	---	--	--	--

OFFENSE CHARGED (<input type="checkbox"/> LOCAL CODE)	OFFENSE DESCRIPTION	CITATION NUMBER	HANDS-FREE DEVICE USED <input type="checkbox"/>	DRIVER DISTRACTED BY <input type="checkbox"/>
---	---------------------	-----------------	--	--

UNIT NUMBER 02	NAME: LAST, FIRST, MIDDLE UNKNOWN, 02, 2018-00021173	DATE OF BIRTH	AGE	GENDER <input type="checkbox"/> F - FEMALE <input type="checkbox"/> M - MALE
--------------------------	--	---------------	-----	--

ADDRESS, CITY, STATE, ZIP	CONTACT PHONE- INCLUDE AREA CODE
---------------------------	----------------------------------

INJURIES <input type="checkbox"/>	INJURED TAKEN BY <input type="checkbox"/>	EMS AGENCY	MEDICAL FACILITY INJURED TAKEN TO	SAFETY EQUIPMENT USED <input type="checkbox"/>	DOT COMPLIANT MOTORCYCLE HELMET <input type="checkbox"/>	SEATING POSITION <input type="checkbox"/>	AIR BAG USAGE <input type="checkbox"/>	EJECTION <input type="checkbox"/>	TRAPPED <input type="checkbox"/>
--------------------------------------	--	------------	-----------------------------------	---	---	--	---	--------------------------------------	-------------------------------------

OL STATE	OPERATOR LICENSE NUMBER	OL CLASS	No VALID OL <input type="checkbox"/>	M/C END. <input type="checkbox"/>	CONDITION	ALCOHOL/DRUG SUSPECTED	ALCOHOL TEST STATUS	ALCOHOL TEST TYPE	ALCOHOL TEST VALUE	DRUG TEST STATUS	DRUG TEST TYPE
----------	-------------------------	----------	---	--------------------------------------	-----------	------------------------	---------------------	-------------------	--------------------	------------------	----------------

OFFENSE CHARGED (<input type="checkbox"/> LOCAL CODE)	OFFENSE DESCRIPTION	CITATION NUMBER	HANDS-FREE DEVICE USED <input type="checkbox"/>	DRIVER DISTRACTED BY <input type="checkbox"/>
---	---------------------	-----------------	--	--

INJURIES 1 - NO INJURY / NONE REPORTED 2 - POSSIBLE 3 - NON-INCAPACITATING 4 - INCAPACITATING 5 - FATAL	INJURED TAKEN BY 1 - NOT TRANSPORTED / TREATED AT SCENE 2 - EMS 3 - POLICE 4 - OTHER 9 - UNKNOWN	SAFETY EQUIPMENT USED MOTORIST 01 - NONE USED - VEHICLE OCCUPANT 02 - SHOULDER BELT ONLY USED 03 - LAP BELT ONLY USED 04 - SHOULDER AND LAP BELT USED	99 - UNKNOWN SAFETY EQUIPMENT NON-MOTORIST 05 - CHILD RESTRAINT SYSTEM-FORWARD FACING 06 - CHILD RESTRAINT SYSTEM- REAR FACING 07 - BOOSTER SEAT 08 - HELMET USED	09 - NONE USED 10 - HELMET USED 11 - PROTECTIVE PADS USED (ELBOWS, KNEES, ETC)	12 - REFLECTIVE CLOTHING 13 - LIGHTING 14 - OTHER
--	---	--	--	--	---

SEATING POSITION 01 - FRONT - LEFT SIDE (MOTORCYCLE DRIVER) 02 - FRONT - MIDDLE 03 - FRONT - RIGHT SIDE 04 - SECOND - LEFT SIDE (MOTORCYCLE PASSENGER) 05 - SECOND - MIDDLE 06 - SECOND - RIGHT SIDE	07 - THIRD - LEFT SIDE (MOTORCYCLE SIDE CAR) 08 - THIRD - MIDDLE 09 - THIRD - RIGHT SIDE 10 - SLEEPER SECTION OF CAB (TRUCK) 11 - PASSENGER IN OTHER ENCLOSED CARGO AREA (NON-TRAILING UNIT SUCH AS A BUS, PICK-UP WITH CAP)	12 - PASSENGER IN UNENCLOSED CARGO AREA 13 - TRAILING UNIT 14 - RIDING ON VEHICLE EXTERIOR (NON-TRAILING UNIT) 15 - NON-MOTORIST 16 - OTHER 99 - UNKNOWN	AIR BAG USAGE 1 - NOT DEPLOYED 2 - DEPLOYED FRONT 3 - DEPLOYED SIDE 4 - DEPLOYED BOTH FRONT/SIDE 5 - NOT APPLICABLE 9 - DEPLOYMENT UNKNOWN
--	--	---	--

EJECTION 1 - NOT EJECTED 2 - TOTALLY EJECTED 3 - PARTIALLY EJECTED 4 - NOT APPLICABLE	TRAPPED 1 - NOT TRAPPED 2 - EXTRICATED BY MECHANICAL MEANS 3 - EXTRICATED BY NON-MECHANICAL MEANS	OPERATOR LICENSE CLASS 1 - CLASS A 2 - CLASS B 3 - CLASS C 4 - REGULAR CLASS (OHIO'S "D") 5 - MC/MOPED ONLY	CONDITION 1 - APPARENTLY NORMAL 2 - PHYSICAL IMPAIRMENT 3 - EMOTIONAL (DEPRESSED, ANGRY, DISTURBED) 4 - ILLNESS	5 - FELL ASLEEP, FAINTED, FATIGUED 6 - UNDER THE INFLUENCE OF MEDICATIONS, DRUGS, ALCOHOL 7 - OTHER	ALCOHOL/DRUG SUSPECTED 1 - NONE 2 - YES - ALCOHOL SUSPECTED 3 - YES - HBD NOT IMPAIRED 4 - YES - DRUGS SUSPECTED 5 - YES - ALCOHOL AND DRUGS SUSPECTED
---	--	--	---	---	---

ALCOHOL TEST STATUS 1 - NONE GIVEN 2 - TEST REFUSED 3 - TEST GIVEN, CONTAMINATED SAMPLE/UNUSABLE 4 - TEST GIVEN, RESULTS KNOWN 5 - TEST GIVEN, RESULTS UNKNOWN	ALCOHOL TEST TYPE 1 - NONE 2 - BLOOD 3 - URINE 4 - BREATH 5 - OTHER	DRUG TEST STATUS 1 - NONE GIVEN 2 - TEST REFUSED 3 - TEST GIVEN, CONTAMINATED SAMPLE/UNUSABLE 4 - TEST GIVEN, RESULTS KNOWN 5 - TEST GIVEN, RESULTS UNKNOWN	DRUG TEST TYPE 1 - NONE 2 - BLOOD 3 - URINE 4 - OTHER	DRIVER DISTRACTED BY 1 - NO DISTRACTION REPORTED 2 - PHONE 3 - TEXTING/E-MAILING 4 - ELECTRONIC COMMUNICATION DEVICE 5 - OTHER ELECTRONIC DEVICE (NAVIGATION DEVICE, RADIO, DVD)	6 - OTHER INSIDE THE VEHICLE 7 - EXTERNAL DISTRACTION
---	--	--	---	---	--

UNIT NUMBER	NAME: LAST, FIRST, MIDDLE	DATE OF BIRTH	AGE	GENDER <input type="checkbox"/> F - FEMALE <input type="checkbox"/> M - MALE
-------------	---------------------------	---------------	-----	--

ADDRESS, CITY, STATE, ZIP	CONTACT PHONE- INCLUDE AREA CODE
---------------------------	----------------------------------

INJURIES <input type="checkbox"/>	INJURED TAKEN BY <input type="checkbox"/>	EMS AGENCY	MEDICAL FACILITY INJURED TAKEN TO	SAFETY EQUIPMENT USED <input type="checkbox"/>	DOT COMPLIANT MOTORCYCLE HELMET <input type="checkbox"/>	SEATING POSITION <input type="checkbox"/>	AIR BAG USAGE <input type="checkbox"/>	EJECTION <input type="checkbox"/>	TRAPPED <input type="checkbox"/>
--------------------------------------	--	------------	-----------------------------------	---	---	--	---	--------------------------------------	-------------------------------------

UNIT NUMBER	NAME: LAST, FIRST, MIDDLE	DATE OF BIRTH	AGE	GENDER <input type="checkbox"/> F - FEMALE <input type="checkbox"/> M - MALE
-------------	---------------------------	---------------	-----	--

ADDRESS, CITY, STATE, ZIP	CONTACT PHONE- INCLUDE AREA CODE
---------------------------	----------------------------------

INJURIES <input type="checkbox"/>	INJURED TAKEN BY <input type="checkbox"/>	EMS AGENCY	MEDICAL FACILITY INJURED TAKEN TO	SAFETY EQUIPMENT USED <input type="checkbox"/>	DOT COMPLIANT MOTORCYCLE HELMET <input type="checkbox"/>	SEATING POSITION <input type="checkbox"/>	AIR BAG USAGE <input type="checkbox"/>	EJECTION <input type="checkbox"/>	TRAPPED <input type="checkbox"/>
--------------------------------------	--	------------	-----------------------------------	---	---	--	---	--------------------------------------	-------------------------------------